



# PHP

## Pressure Transmitter for Precision Measurements

The **PHP** digital pressure transducer is a high accuracy and performance for precision pressure measurement component that uses either RS-232 to communicate with host computer and analog output. The PHP have a excellent small temperature error below 0.035% in the range of -10 ~ 50°C. The communication S/W is included in delivery.

- VDC, mA Analog output
- RS232 Digital output
- Measuring range 0 ~ 1500 bar
- 0.035%FS accuracy
- Gauge and absolute measurement
- Stainless steel media-wetted materials
- CE Certified
- Measurement and test benches
- Calibration technology
- Laboratories
- Plant construction and machine building

### 01 Specification

Range	Gauge Pressure	0 ~ 150, 350 mbar / 1, 2, 3.5, 7 bar 0 ~ 20, 35, 70, 100, 200, 250, 350, 400, 600, 1000, 1500 bar
	Absolute Pressure	0 ~ 1, 2, 3.5, 7 bar / 0 ~ 20, 35, 70 bar
	Compound Pressure	-1 ~ 1, 2, 3.5, 7 bar / -1 ~ 20, 35 bar
Performance	Accuracy	±0.035% FS (Gauge pressure) ±0.05% FS (Compound, Absolute pressure)
	Thermal Effect on Zero	±0.035% FS
	Thermal Effect on Span	±0.035% FS
	Long-term Stability	±0.05% FS/year
	Compensated Temp. Range	-10 ~ 50 °C
	Operating Temp. Range	-20 ~ 80 °C
Electrical	Excitation	11 ~ 32 VDC
	Analog Output	0 ~ 5 VDC, 1 ~ 5 VDC, 0 ~ 10 VDC, 4 ~ 20 mA (3, 4 wire)
	Digital Output	RS232 (19200, 8, n, 1)
	Electrical Connection	TAJIMI PRC03-21A10-7F / PRC03-12A10-7M10.5 + 3m cable
Physical	Proof Pressure	≤1000 bar : 150%FS Max. / >1000 bar : 110%FS Max.
	Burst Pressure	≤1000 bar : 200%FS Min. / >1000 bar : 110%FS Min.
	Vibration	49.1 m/s <sup>2</sup> {5G}, 10~500Hz
	Shock	490 m/s <sup>2</sup> {50G}
	Pressure port	1/8" PT, 1/8" PF, 1/4" PT, 1/4" PF, 1/4" NPT, 3/8" PT, 3/8" PF, 9/16" UNF
	Media-Wetted Materials	Stainless Steel 316L, Viton (>350 bar : Stainless Steel 303, Titanium 87% Alloy)
	Weight	Connector type : Approx. 270g (Sensor Only)



# PHP

## 02 DIMENSIONS

≤ 35 bar

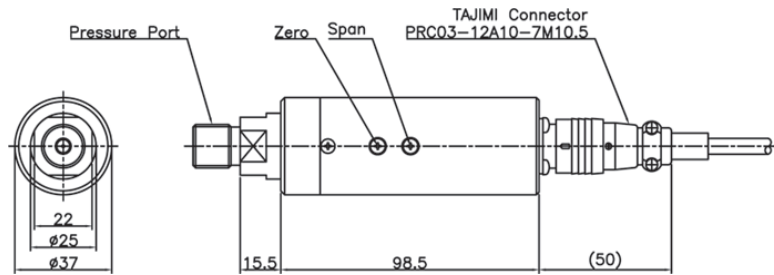

Pin No.	Wire Color	Connections
A	White	GND
B	Red	Excitation ⊕
C	Shield	FG
D	Green	Analog Output ⊕
E	Yellow	TXD
F	Black	GND
G	Blue	RXD

> 35 bar

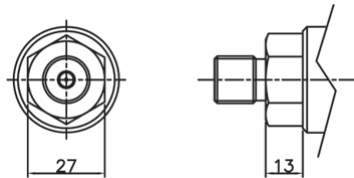

## 03 Order Information

Ex) PHP - 100 M G N E (PHP-100MGNE)

<p><b>Pressure Unit</b></p> <p>R: kPa      M: MPa          B: bar      K: kgf/cm<sup>2</sup>          P: psi      H: mmHg          I: inchHg    T: Torr          D: mmH<sub>2</sub>O    C: cmH<sub>2</sub>O          N: inchH<sub>2</sub>O</p>	<p><b>Analog Output</b></p> <p>E = 1~5 V    C = 0~5 V          J = 0~10 V    G = 4~20 mA          N = None</p>
<p><b>Pressure Type</b></p> <p>G = Gauge    A = Absolute          C = Compound</p>	<p><b>Pressure port</b></p> <p>A = 3/8 PT    E = 1/2 PT          B = 3/8 PF    Q = 1/2 PF          C = 1/4 PT    G = 1/8 PT          D = 1/4 PF    H = 1/8 PF          K = 9/16" UNF(Only ≥ 1000 bar)          L = 1/4 NPT</p>